



Tee Nuts Increased Holding Power for Wood Applications.

Tee Nuts are often used in furniture builds, cabinet builds, and light framing of wood storage compartments. Earnest Machine stocks Carbon Steel Tee Nuts in sizes ranging from 1/4" to 3/8" in diameter and offers multiple barrel heights for various thicknesses of wood. The 3-prong style provides easier installation in hardwoods while the 4-prong style provides higher holding power in softwoods.

PRODUCT ATTRIBUTES

3- and 4-prong Tee Nuts available
Diameters range from 1/4" to 3/8"
Barrel heights range from 5/16" to 5/8"
Available in RoHS compliant Zinc Clear Trivalent

MARKETS FOR TEE NUTS

Cabinets
Furniture
Light Framing

THIS PRODUCT IS OFTEN CALLED

Barrel Nut
Prong Nut

ADDITIONAL FASTENERS WE SUPPLY FOR WOOD APPLICATIONS

Machine Screws
Wood Screws
Drywall/Particle Board Screws
Timberjack Premium Timber Screws

AVAILABLE VALUE ADDED SERVICES

Bulk and full case quantities
Secondary and rework services available
Custom packaging services
Custom plating

BACKED BY THE EARNEST

Service
GUARANTEE

Inquire today at **+1 (800) 327-6378** or visit **EarnestMachine.com**

3- AND 4-PRONG CARBON STEEL TEE NUTS FOR WOOD

Earnest Machine stocks Carbon Steel Tee Nuts in sizes ranging from 1/4" to 3/8" in diameter. The 3-prong style provides easier installation in hardwoods while the 4-prong style provides higher holding power in softwoods.

THREADS

Unified Threads (UNC) Class 2B

Threads made to requirements of ASME B1.1

Thread acceptance per ASME B1.3, System 21

PLATING

Zinc Clear (RoHS compliant Cr3+)

*The specifications shown on this sheet are not intended to be used in the production of parts. Earnest Machine is not responsible or liable in any manner for any production errors and we certify the information present on this specification sheet is correct to the best of our knowledge.

©2023 Earnest Machine Products

PRODUCT DRAWINGS

3-Prong Carbon Steel Tee Nuts for Wood

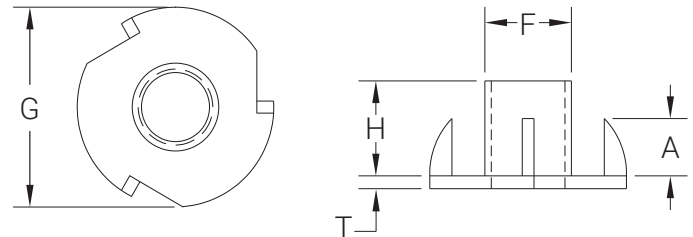

4-Prong Carbon Steel Tee Nuts for Wood

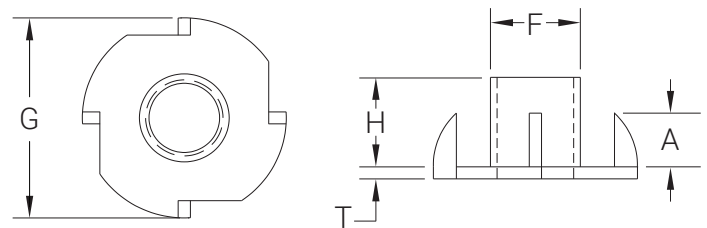

3-PRONG CARBON STEEL TEE NUTS FOR WOOD

SIZE	BARREL HEIGHT (H)	FLANGE DIAMETER (G)	BARREL DIAMETER (F)	PRONG HEIGHT (A)	MATERIAL THICKNESS (T)	DRILL SIZE
1/4 - 20	5/16	3/4	0.305	7/32	0.047	5/16
1/4 - 20	7/16	3/4	0.305	7/32	0.047	5/16
1/4 - 20	9/16	3/4	0.305	7/32	0.047	5/16
5/16 - 18	3/8	7/8	0.390	1/4	0.063	25/64
5/16 - 18	5/8	7/8	0.390	5/16	0.063	25/64
3/8 - 16	3/8	1	0.440	9/32	0.063	29/64
3/8 - 16	7/16	1	0.440	11/32	0.063	29/64

4-PRONG CARBON STEEL TEE NUTS FOR WOOD

SIZE	BARREL HEIGHT (H)	FLANGE DIAMETER (G)	BARREL DIAMETER (F)	PRONG HEIGHT (A)	MATERIAL THICKNESS (T)	DRILL SIZE
1/4 - 20	5/16	3/4	0.305	7/32	0.047	5/16
1/4 - 20	7/16	3/4	0.305	1/4	0.047	5/16
1/4 - 20	9/16	3/4	0.305	1/4	0.047	5/16
5/16 - 18	3/8	7/8	0.390	1/4	0.063	25/64
5/16 - 18	5/8	7/8	0.390	5/16	0.063	25/64
3/8 - 16	3/8	1	0.440	9/32	0.063	29/64
3/8 - 16	7/16	1	0.440	11/32	0.063	29/64